

ES 1.5HT

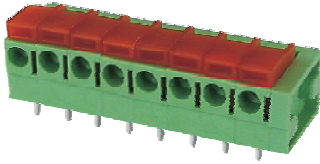

Pitch:5.08 mm

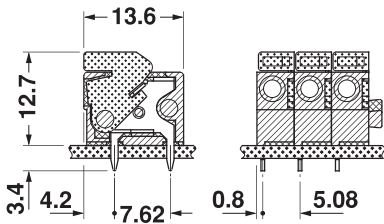

ES 1.5VT

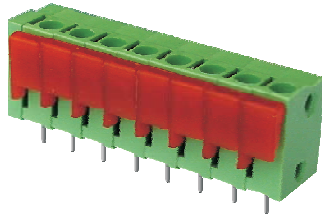

Pitch:5.08 mm

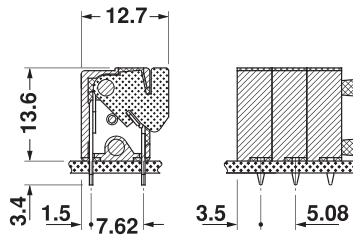

IEC 数据	刚性导线 (mm ²)	柔性导线 (mm ²)	AWG	I (A)	U (V)
连接数据	0.2-1.5	0.2-1.5	24-16	15	250
绝缘材料组别	I				
污染等级	3 2 2				
过电压类别	III III II				
额定电压(V)	250 320 630				
额定冲击电压(KV)	4				
绝缘材料/阻燃等级 UL 94	PA/V0				
螺钉/扭矩(-/Nm)	\				
剥线长度(mm)	10				
线路板孔径(mm)	Ø1.3				
引脚尺寸 (mm)	0.5X1				

UL 数据		
额定电压(V)/电流(A)		300/10
压线范围(AWG)		22-16

IEC	Rigid (mm ²)	flexible (mm ²)	AWG	I (A)	U (V)
Connection data	0.2-1.5	0.2-1.5	24-16	15	250
Insulating Material Group	I				
Pollution degree	3 2 2				
Overvoltage Category	III III II				
Rate Voltage(V)	250 320 630				
Rate impulse Voltage(KV)	4				
Insulating material/Inflammability Class	PA/V0				
Screw/Torque(-/Nm)	\				
Stripping length(mm)	10				
PCB Hole Diameter(mm)	Ø1.3				
Pin Dimensions(mm)	0.5X1				

UL Technical Data		
Rate Voltage(V)/Current(A)		300/10
Wire Range(AWG)		22-16

位数/No. of positions	订货型号/Order No.
2	ES 1.5HT-2-5.08
...	...
24	ES 1.5HT-24-5.08

IEC 数据	刚性导线 (mm ²)	柔性导线 (mm ²)	AWG	I (A)	U (V)
连接数据	0.2-1.5	0.2-1.5	24-16	15	250
绝缘材料组别	I				
污染等级	3 2 2				
过电压类别	III III II				
额定电压(V)	250 320 630				
额定冲击电压(KV)	4				
绝缘材料/阻燃等级 UL 94	PA/V0				
螺钉/扭矩(-/Nm)	\				
剥线长度(mm)	10				
线路板孔径(mm)	Ø1.3				
引脚尺寸 (mm)	0.5X1				

UL 数据		
额定电压(V)/电流(A)		300/10
压线范围(AWG)		22-16

IEC	Rigid (mm ²)	flexible (mm ²)	AWG	I (A)	U (V)
Connection data	0.2-1.5	0.2-1.5	24-16	15	250
Insulating Material Group	I				
Pollution degree	3 2 2				
Overvoltage Category	III III II				
Rate Voltage(V)	250 320 630				
Rate impulse Voltage(KV)	4				
Insulating material/Inflammability Class	PA/V0				
Screw/Torque(-/Nm)	\				
Stripping length(mm)	10				
PCB Hole Diameter(mm)	Ø1.3				
Pin Dimensions(mm)	0.5X1				

UL Technical Data		
Rate Voltage(V)/Current(A)		300/10
Wire Range(AWG)		22-16

位数/No. of positions	订货型号/Order No.
2	ES 1.5VT-2-5.08
...	...
24	ES 1.5VT-24-5.08